

ENGLISH

SCOPE OF DELIVERY & SAFETY INSTRUCTIONS

AURORA *VE*



Giesemann Aquaristic GmbH
Bürdestr. 14 · D-41334 Nettetal
Tel. +49 - 2157 / 81 29 90
Fax +49 - 2157 / 81 29 99
www.giesemann.de
info@giesemann.de

SCOPE OF DELIVERY & SAFETY INSTRUCTIONS



Dear customer, thank you for your confidence in Giesemann quality products.

Our experience in the field of aquaristics and modern lighting technology guarantees the quality standard of our products. Please read these operating instructions carefully to ensure optimum function and operational safety for years to come.

Failure to observe the following points may be dangerous or even violate existing directives.



All Giesemann products bear the CE mark. This mark can usually be found on the type plate inside the product, the power cord or on the external control box.



After unpacking, please check that your item is in good condition and that the scope of delivery is complete. Any damage must be reported to your dealer immediately in order to assert any warranty claims.

The luminaires may only be installed by authorized electricians. The luminaire must not be operated if damage is evident, a malfunction occurs, or after fall, immersion in water or other defects.



The luminaires must never be operated without the appropriate protective shields; damaged protective shields must be replaced immediately to ensure adequate splash protection.

The luminaires described are intended exclusively for lighting and supplementary lighting of indoor aquariums.



The lighting must be permanently installed with a minimum distance of 15 cm to the water surface above the aquarium and must never be operated under water. They must not be placed on the edge of the aquarium or installed in or behind paneling or covers.



It is essential to protect the luminaires and the electrical operating devices from direct splash-water and high humidity.



Use the luminaires with the utmost care when children or persons who cannot assess the dangers are in the vicinity of the luminaires.

Packaging materials must not be used for playing; there is a risk of suffocation!



Never look directly into the light source. Bright light can cause eye injuries!

SCOPE OF DELIVERY & SAFETY INSTRUCTIONS



Maintenance work on the light unit may only be carried out when they have been dismantled from the ceiling or wall and completely disconnected from the electrical mains. For safety reasons, please note that work on the aquarium may only be carried out when the lighting has been completely disconnected from the mains (pull out the mains plug).



Do not attempt to open an LED light module or the power supply unit, as damaging the internal seals will invalidate the warranty.



The luminaire housing and the protective glass can become very hot during operation: Take care when touching. When cleaning, take special care to prevent moisture from entering the interior of the luminaires through the ventilation openings. Never cover the ventilation grilles with objects, and always ensure that there is sufficient heat exchange in any case.

Improper use will invalidate any warranty claims. The luminaires must be transported and stored in their original packaging.



The luminaires are made of saltwater-resistant aluminium and have a high-quality powder coating. To keep the housing clean and the light surfaces clear, regular care with a slightly damp cloth is sufficient. Please note that salt deposits must always be removed immediately, otherwise even high-quality surfaces will be damaged over time. Failure to carry out maintenance work will result in loss of warranty.



Disposal: When the end of use has been reached, render the disused luminaires unusable by pulling the plug out of the socket and cutting the cable. Dispose of the luminaires in accordance with the environmental regulations in force in your country. Electrical waste must not be with household waste. Contact your local authority or dealer for advice on recycling.

CE Declaration of Conformity The company

Gieseemann Lichttechnik & Aquaristik GmbH
Bürdestraße 14 – 41334 Nettetal – Germany
declare under our sole responsibility that the products:

AURORA V8

to which this declaration relates are in conformity with the technical requirements of the following European Community directives & standards or other normative documents

- 98/37/EC / - EEC 89/336 - EEC 73/23 AND RELATED AMENDMENTS AND ADDITIONS (B.T.)

The following technical standards and specifications have been observed:

Safety: EN 60335-1 / EN 60335-2- 55 AND RELATED AMENDMENTS / EN 292-1-2 / CEI 61-50

EMC directive: EN 50081-1 / EN 50081-2 and the following amendments / EN 5008

16.05.2021, Nettetal - Germany

INSTALLATION



The installation of your AURORA V12 above your aquarium is done by means of a special steel cable suspension for weight reasons (not included in delivery).

Installation of the AURORA V8 using steel cable suspension:

The luminaire has two guide grooves in the upper area with inserted square nuts.

These can be flexibly moved in the guide rails. Screw the two cross ropes of the optional suspension cable set to the desired position of the luminaire using the enclosed screws. By loosening the lower screw of the holder, inserting the wire into the groove and retightening the screw.

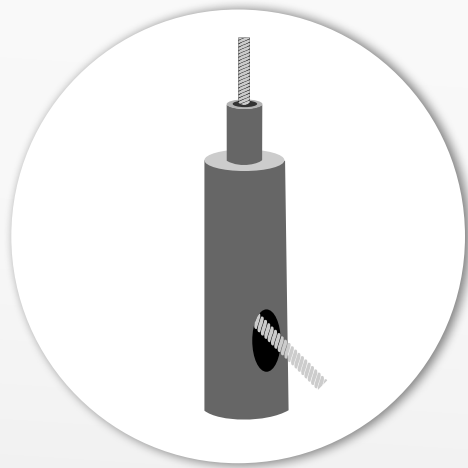
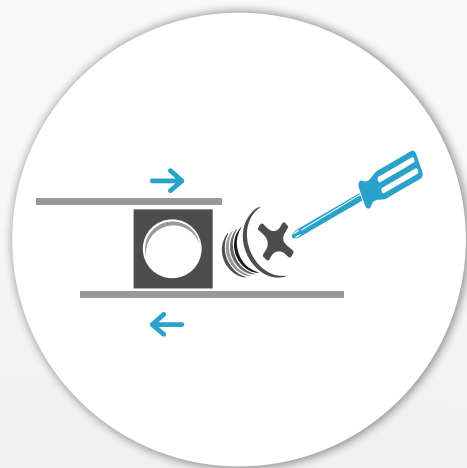

Mount the ceiling fasteners with suitable screws and dowels. Screws and dowels are not included in the scope of delivery, since different conditions always require individual mounting components. When mounting, make sure that the masonry # on site provides sufficient support.



If necessary, special fastening systems, such as cavity dowels, hinged screws, etc. Please consult a specialist company in case of insecurities and special ceiling systems.

Now guide the steel cable into the hole of the screw cap. Screw it into the ceiling fastener. Guide the end of the steel cable into the upper opening hole of the ceiling fastener.

As the pole set is equipped with a stepless height adjustment, the luminaire can be locked in place by pressing on the nozzle of the spring mechanism.

For safety reasons, the luminaire must be lifted slightly before adjustment; if the luminaire hanger is then loaded again, the luminaire locks into place automatically.

Now align your AURORA V8 horizontally above the tank.

THE POWER SUPPLY



Between the luminaire and the power socket, the cable must form a drip loop so that dripping water cannot get into the power socket.

Attempts to this connection with controllers or similar will result in immediate loss of warranty.

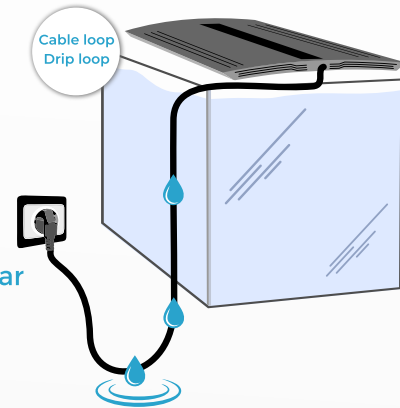

STARTING YOUR AURORA V12



After connecting the plug / light to the mains the power socket automatically with initialization. The luminaire is immediately ready for operation and can now be programmed via **the lynk app**.

A tablet computer or a smartphone with Bluetooth function is required for programming the built-in light control

(the tablet or smartphone are not included in the scope of delivery).

The app can be downloaded from the google play store or the Apple app store under the name **“lynk smart control”**



For the operation of the app, please refer to the separate operating instructions for lynk control.

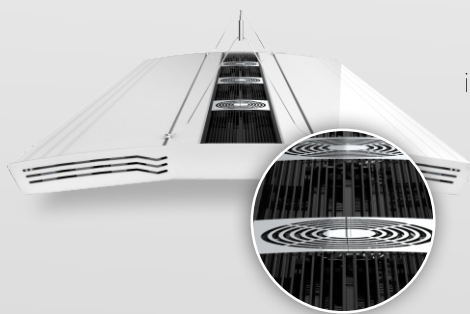

The fans are temperature-controlled, i.e. the speed increases as the temperature inside the luminaire rises. Nevertheless, the luminaire must not be installed in closed canopies or behind coverings.

Depending on the internally measured temperature on each single LED board and the T-5 sections, the fans are automatically switched on in stages.



TROUBLESHOOTING ASSISTANCE

We have taken great care with your AURORA V12, the software and the accompanying descriptions. Despite the greatest care and all kinds of technical assistance - our products are made by humans.

Therefore, errors cannot be excluded. We welcome constructive criticism and suggestions. Help with questions of understanding or technical problems can be found in the support area at

<http://giesemann.de/support>.

MALFUNCTIONS



The luminaire can be integrated into your home WLAN. Depending on the configurations of your WLAN network complications which do not mean a malfunction or technical problem of the luminaire.

Please read the manual of the "lynk" app carefully or have a look at our website at our website in the FAQ section to exclude possible error sources.

www.giesemann.de/faq

Please make sure that you register your new GIESEMANN product on our website. Only with valid registration and the original proof of purchase will you receive the full warranty for your product.

Enjoy your new AURORA V8 and the perfect light above your aquarium.



Giesemann Aquaristic GmbH
Bürdestr. 14 · D-41334 Nettetal
Tel. +49 - 2157 / 81 29 90
Fax +49 - 2157 / 81 29 99
www.giesemann.de
info@giesemann.de